

FLAT SEAL

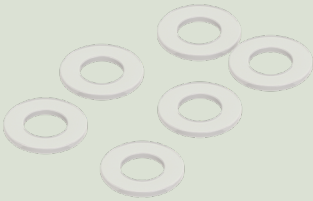

Labo & Analyse, Industriële processen

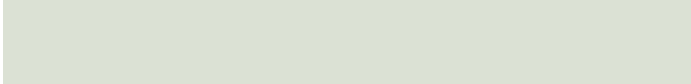

Producten:

Referentie	Korte beschrijving:
151862	FLAT SEAL PA 6.6 FOR P. GAUGE G1/4
151606	JOINT PLAT - CU RECUIT G1/4 (X10)
151607	FLAT SEAL - CU ANNEALED M 10X1
17085	ZAKJE 3 MET PAKKINGEN KEL-F MANO
17124	5 DICHT KELF FOR KOP DIRS
17204	PAKKING KELF MANO 1/4
137203	PAKKING CU DIAMETER 14,2X11X1,5 (X10)
167872	DICHTING KIT PCTFE OVERDRU. VENTIEL SGA2
167942	DICHTING INLAATAANSLUITING EUROJET N2
186086	SET DICHTING VLA 11,2X5,5X1,5 PCTFE SGA2
186087	SET DICHTINGEN 9,4X5,4X3,2 KOPER SGA2
84154	PAK PEEK 29x15.1x4 mm (BUNDEL O2) (x10)
84155	PAK PEEK 34x15.1x4 mm (BUNDEL N2) (X10)
84156	JOINT PEEK 38X20X4 MM (CADRE H2) (X10)
29215	FLAT SEAL PTCFE (KEL-F®) 21X8X2
124737	JOINT POUR MANO G1/4 5,2x9,6x3 ALU
167800	DICHTING KIT PA 6.6 VOOR MANO 10X1
160143	KIT AFDICHTINGEN KOPER MANOMET G1/4° DCn
17137	PAKKING PTFCE 14,25X11X1,5
17203	PAKKING KELF 18X11,8X2
17140	PAKKING POLYAMIDE 14,5X10X2
17206	ZAKJE MET PAKKINGEN D11 EP 1 EN EP 0.5
17207	ZAKJE MET 10 PAKKINGEN KELF 18X7X2
18561	FLAT SEAL RILSAN FOR P. GAUGE G1/4
19431	FLAT SEAL PA 6.6 10X6X3
29053	FLAT SEAL PA 6-6 20x12x2
29186	FLAT SEAL PA 6-6 14x9x2
29187	PACKNING 18X11,8X2 MM NYLON
29214	FLAT SEAL PTCFE (Kel-F®) 14x9x2
29222	FLAT SEAL PTCFE (Kel-F®) 18,5x11x2
29223	FLAT SEAL PTCFE (Kel-F®) 16,9x10,7x2
29226	FLAT SEAL PTCFE (Kel-F®) 16x9,2x2

Referentie	Korte beschrijving:
82070	PAKKING KEL-F 18X12X2MM
168036	FLAT SEAL PTFCE VANNE DE PURGE SGA2
17141	DICHTING PLAT KELF 10 14.5 PRES REG